

# P3 OWNER'S MANUAL ERRATA

Rev. G-1, February 12, 2016

E740152E

**MAKE THESE CHANGES TO YOUR REV G MANUAL OR ANNOTATE THE TEXT TO REFER TO THIS ERRATA AT THE PLACES INDICATED.**

1. **Page 4, Connections**, add the following at the bottom:
  - If you have a device such as a STEPP-IR antenna controller or pc program that monitors the RS232 port, sense the RS232 signals at the PC connector at the P3. **Never attempt to sense the RS232 signals at the XCVR connector.**
2. **Page 10, Introduction, second paragraph**: change "...firmware version 1.29..." to "...firmware version 1.50 or later..."

**⚠ UNLESS OTHERWISE NOTED, CABLES ARE SUPPLIED WITH THE P3**

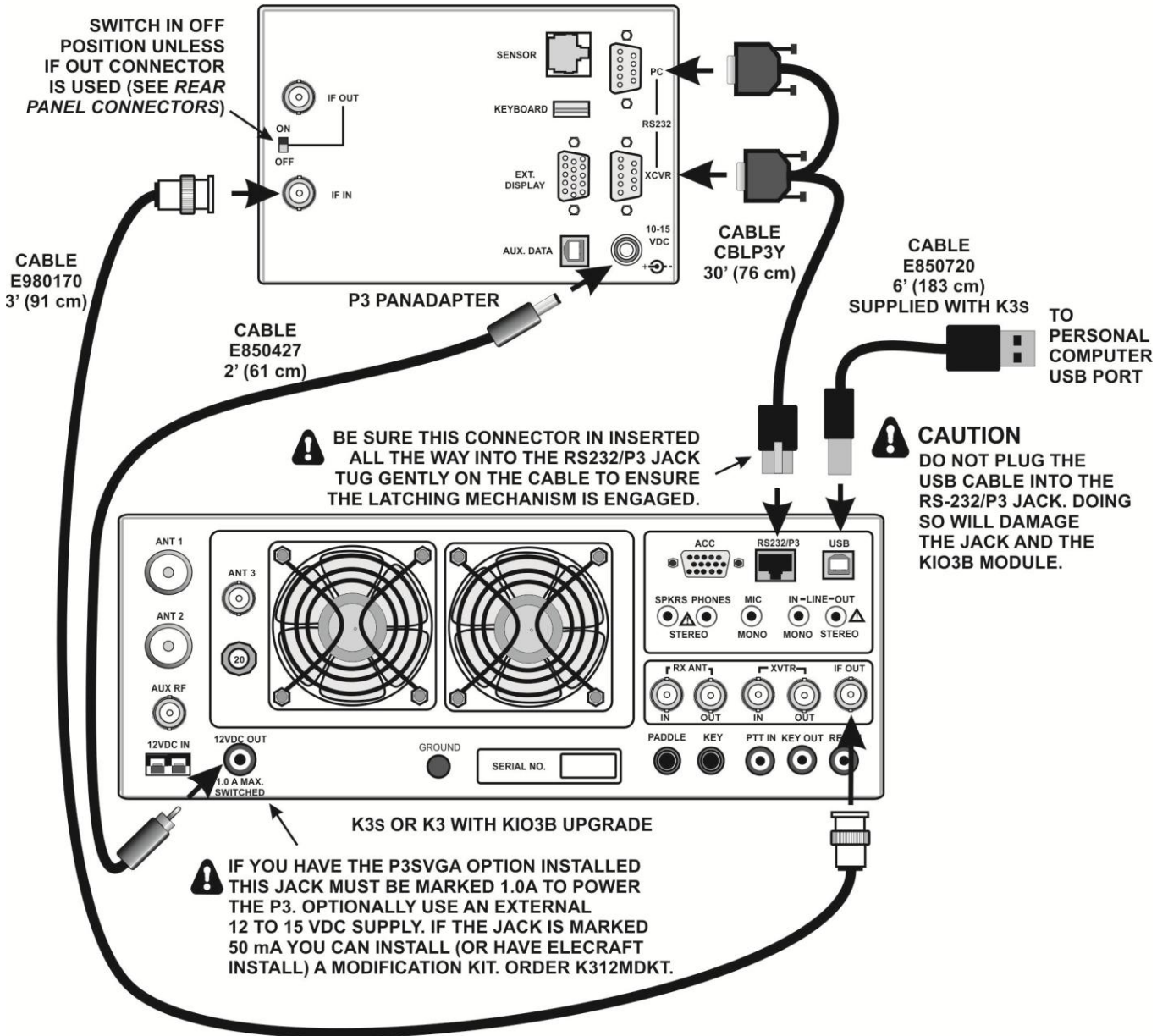

BASIC K3S/P3 CABLING FOR USB INTERFACE TO PERSONAL COMPUTER

**⚠ UNLESS OTHERWISE NOTED, CABLES ARE SUPPLIED WITH THE P3**

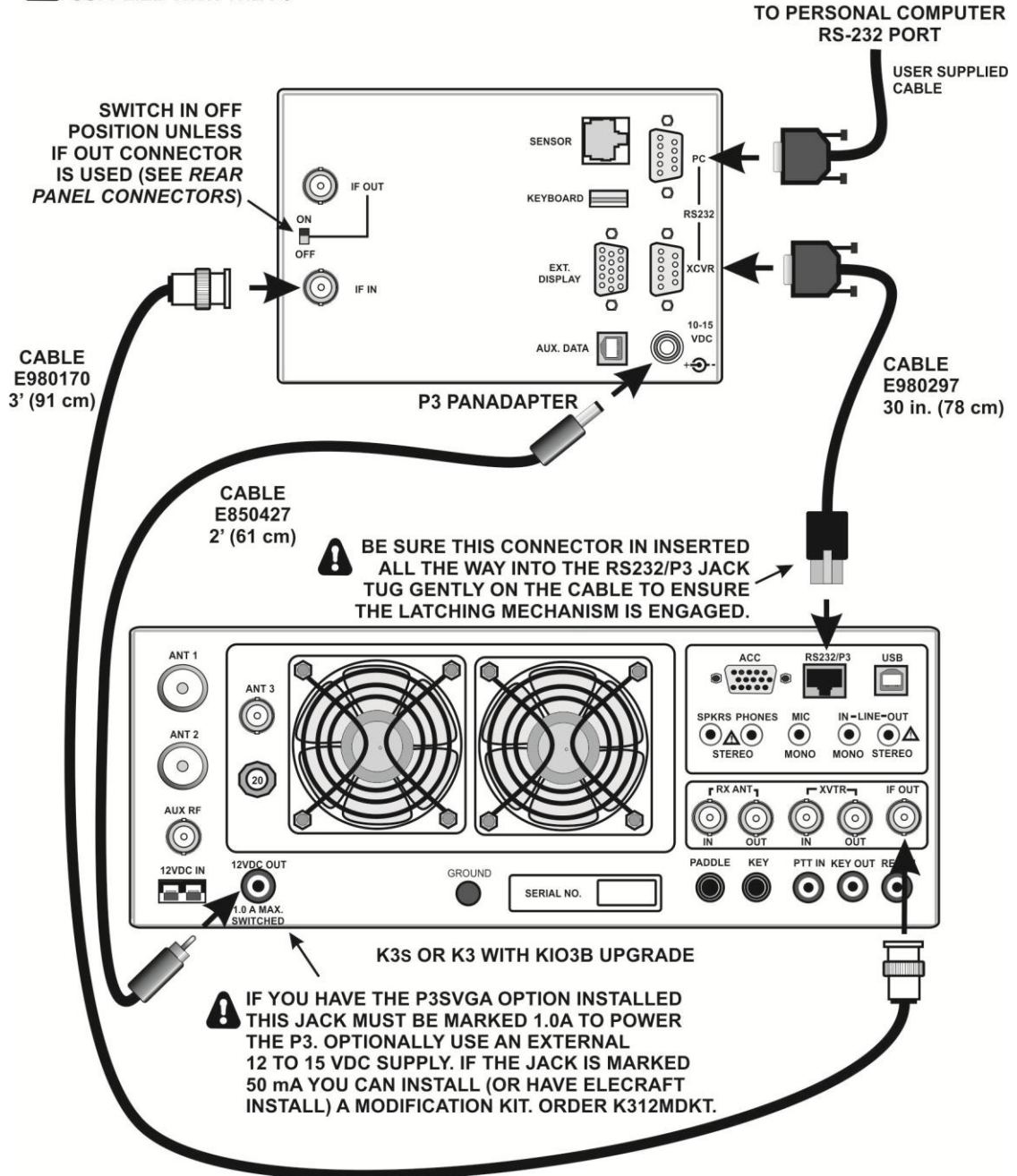

**BASIC K3S/P3 CABLING FOR RS-232 INTERFACE TO PERSONAL COMPUTER**

**⚠ UNLESS OTHERWISE NOTED, CABLES ARE SUPPLIED WITH THE P3**

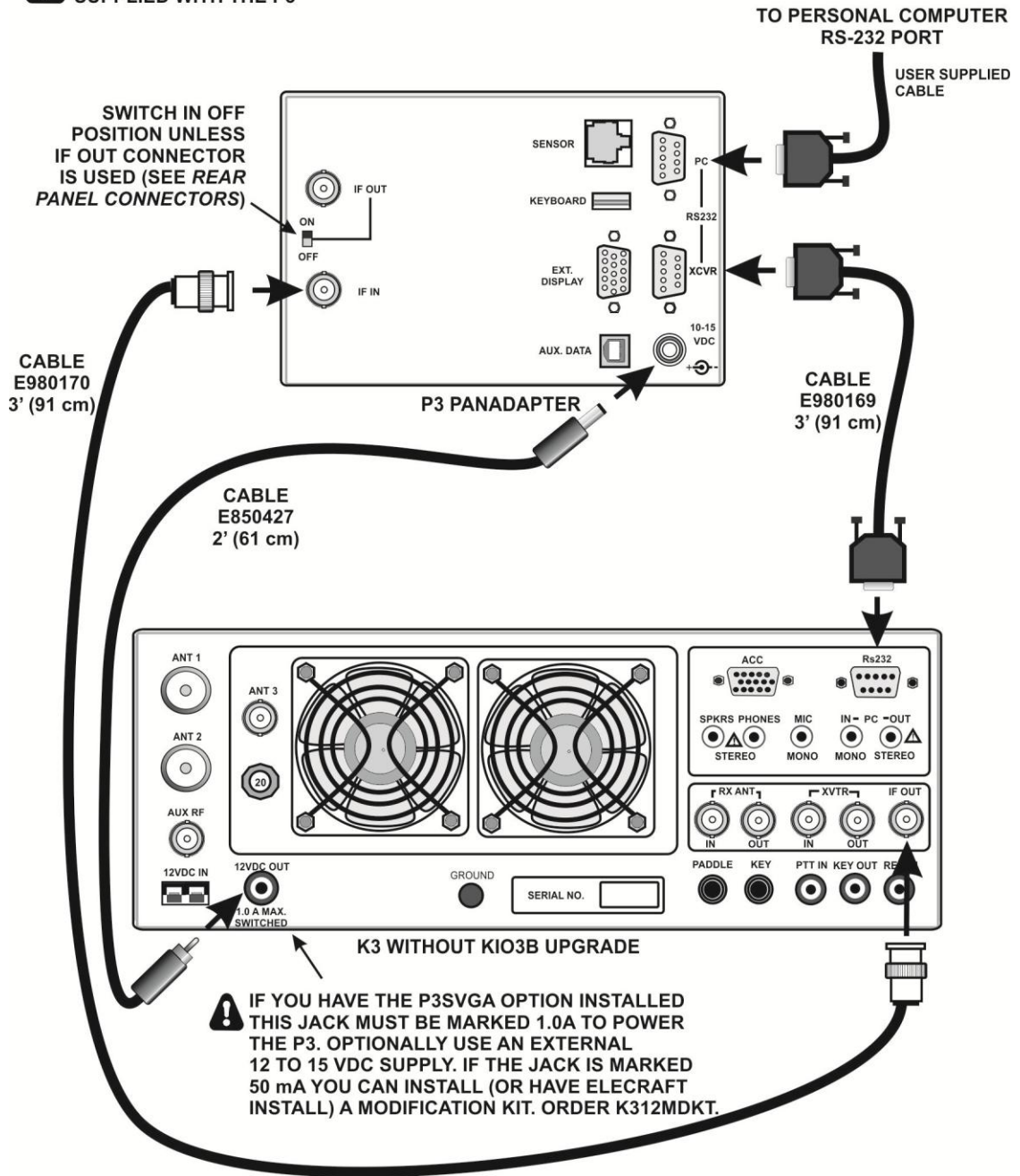

**BASIC K3/P3 CABLING FOR RS-232 INTERFACE TO PERSONAL COMPUTER**

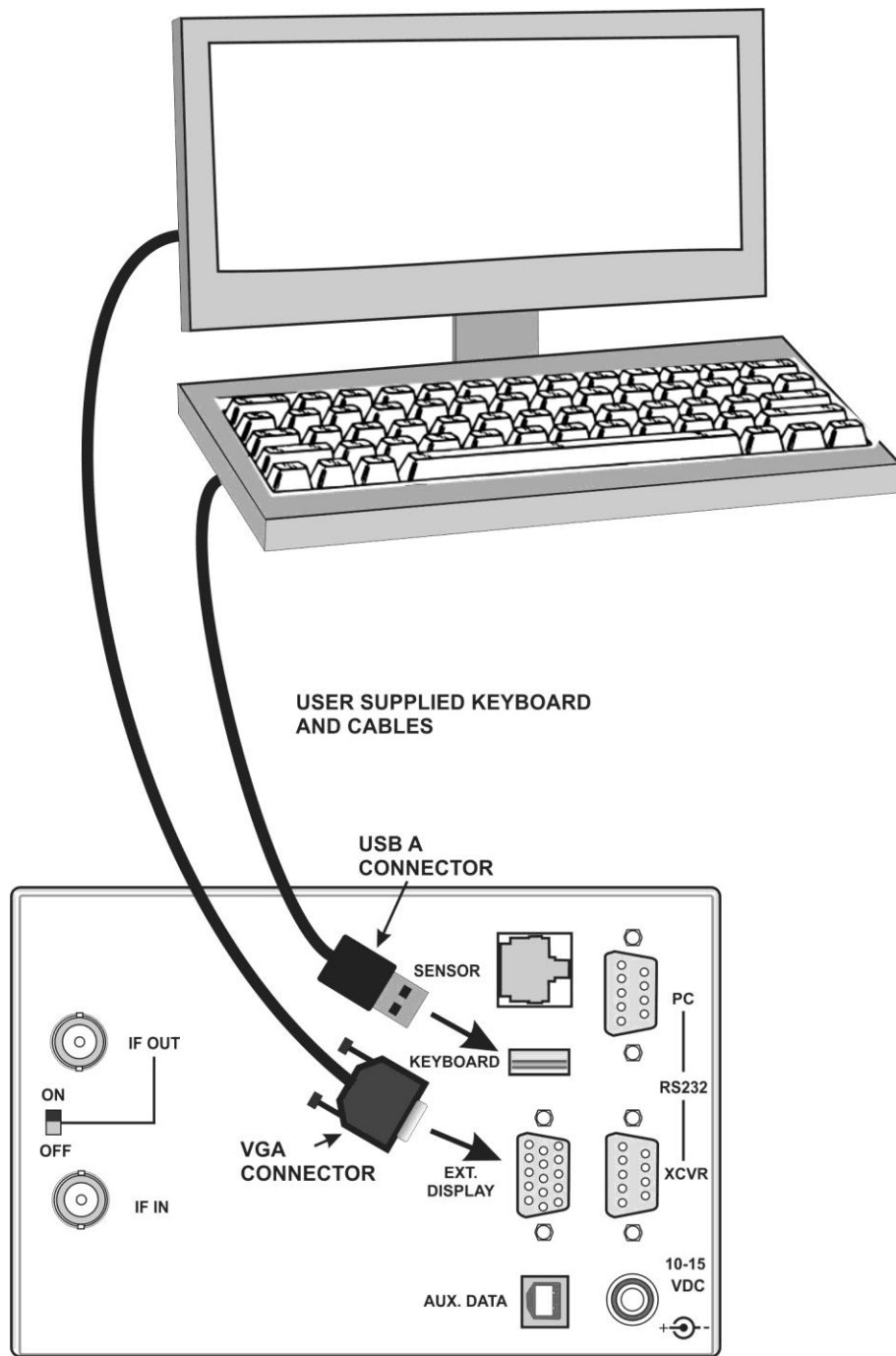

USER SUPPLIED KEYBOARD  
AND CABLES

USB A  
CONNECTOR

SENSOR

KEYBOARD

PC

RS232

XCVR

VGA  
CONNECTOR

EXT.  
DISPLAY

AUX. DATA

10-15  
VDC

ADDITIONAL CABLING IF P3SVGA OPTION INSTALLED